

Quick Start Guide

Stylus 730

Start Here

The camera you have purchased is equipped with "Normal mode" and "Simple mode". This manual presumes that you are using the camera in "Normal mode", which is the default setting. For instructions on how to switch between "Normal mode" and "Simple mode" and how to operate the camera in "Simple mode", refer to the "Advanced Manual".

For more information, please refer to the Basic & Advanced Manuals or visit: www.olympusamerica.com/support

OLYMPUS IMAGING AMERICA INC.

1 Gather these items (box contents)

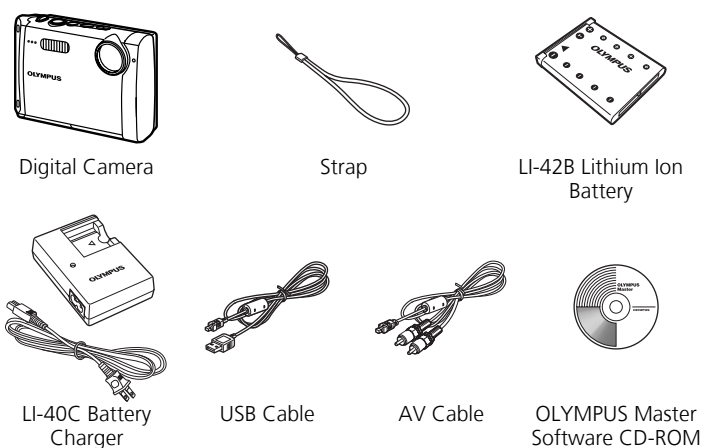

Items not shown: Advanced Manual (CD-ROM), Basic Manual, and warranty card. Contents may vary depending on purchase location.

Attach the strap

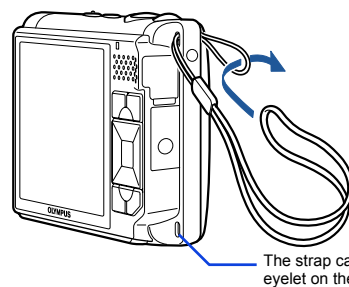

● Pull the strap tight so that it does not come loose.

2 Prepare the battery

a. Charge the battery

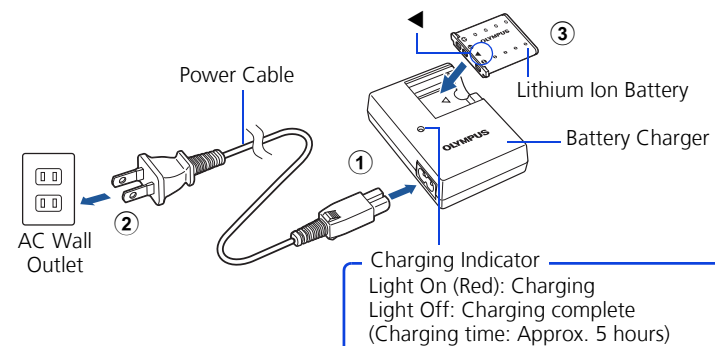

● Battery comes partially charged.

b. Insert the battery in the camera

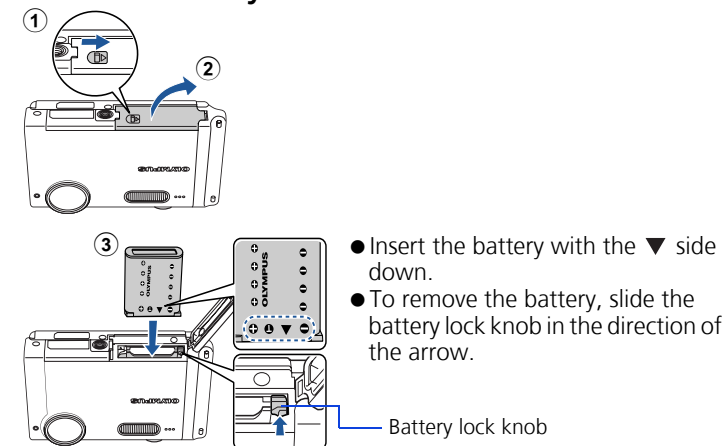

3 Turn the camera on

a. Press the POWER button

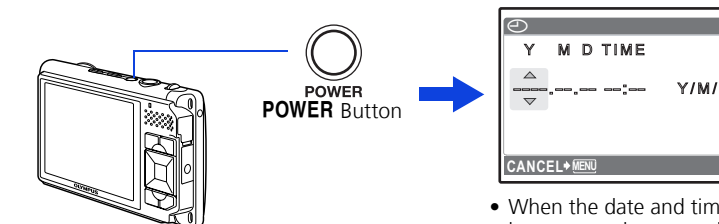

● When the date and time have not yet been set, this screen will appear.

● To turn off the camera, press the POWER button once again.

Hint

The directions of the arrow pad (▲▼◀▶) is indicated with ▲▼◀▶ in the supplied instruction manual.

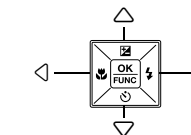

4 Set date and time

About the date and time setting screen

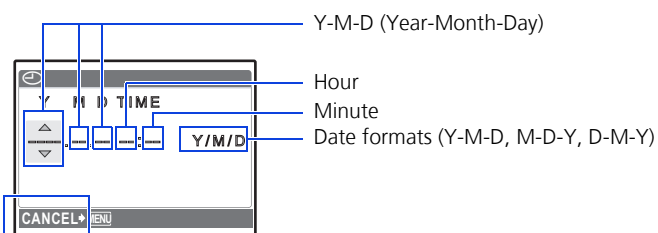

Exits a setting.

a. Press the ▲ button and the ▼ button to select [Y].
● The first two digits of the year are fixed.

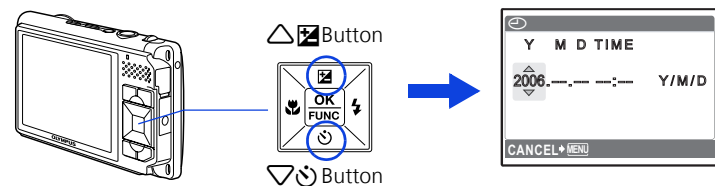

b. Press the ▶ button.

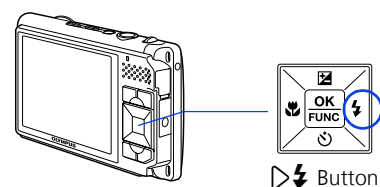

c. Press the ▲ button and the ▼ button to select [M].

d. Press the ▶ button.

e. Press the ▲ button and the ▼ button to select [D].

f. Press the ▶ button.

g. Press the ▲ button and the ▼ button to select "hour", "minute".
● The time is displayed in the 24-hour format.

h. Press the ▶ button.

i. Press the ▲ button and the ▼ button to select [Y/M/D].

j. After all items have been set, press the OK button.

● For precise time setting, press the OK button as the time signal strikes 00 seconds.

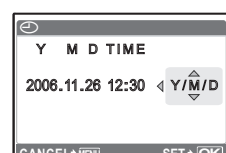
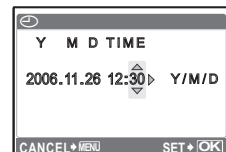
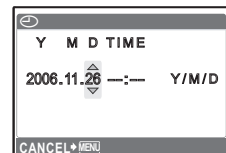
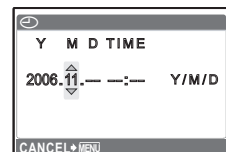
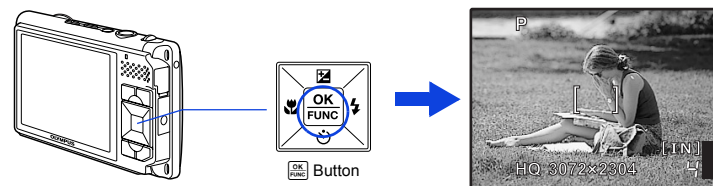

5 Take a picture

a. Hold the camera



b. Focus

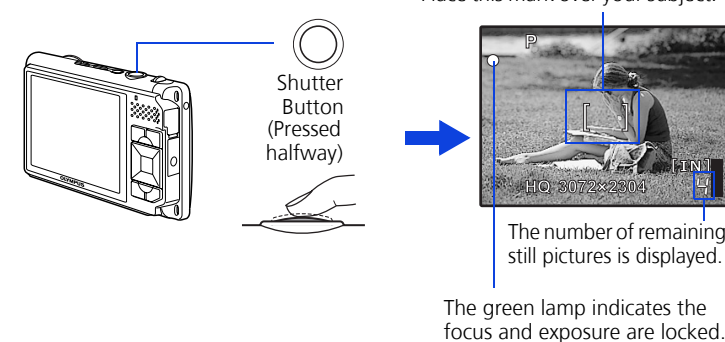

c. Shoot

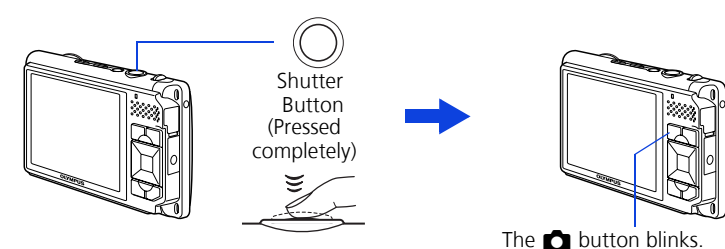

6 Review your pictures

a. Press the ▶ button.

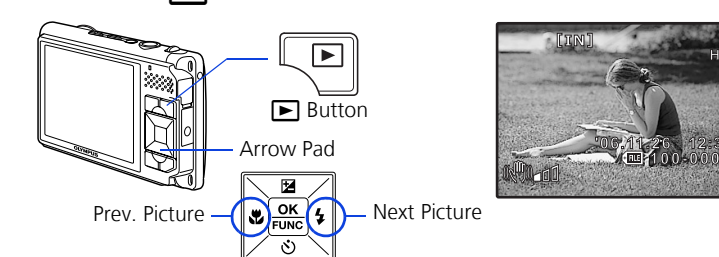

Erase pictures

a. As described in a. above, display the picture you want to erase.
b. Press the button.

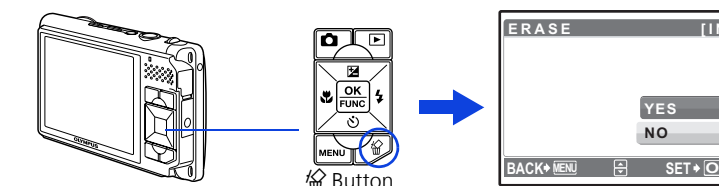

c. Press the ▲ button to select [YES] and press the button to erase the image.

